

POS.	PART NUMBER	PART NAME	QUANTITY
1	6591322	DAMPENER HOUSING PE TN	1
1	6591323	DAMPENER HOUSING PE TB	1
1	6591215	DAMPENER HOUSING PE-C TN	1
1	6591216	DAMPENER HOUSING PE-C TB	1
1	6591217	DAMPENER HOUSING AL TN	1
1	6591218	DAMPENER HOUSING AL TB	1
1	6591219	DAMPENER HOUSING SS TN	1
1	6591220	DAMPENER HOUSING SS TB	1
2	6590870	CENTER SECTION PA6	1
2	6590871	CENTER SECTION PE-C	1
3	6590346	DIAPHRAGM EPDM	1
3	6590347	DIAPHRAGM PTFE	1
4	6590872	DAMPENER SHAFT	1
5	6590875	SHAFT BEARING SET	1
6	6591269	ASSEMBLY PIN PLASTIC SET	4
6	6591270	ASSEMBLY PIN METAL SET	4
7	6590873	CAP	1
7	6590874	CAP CONDUCTIVE	1

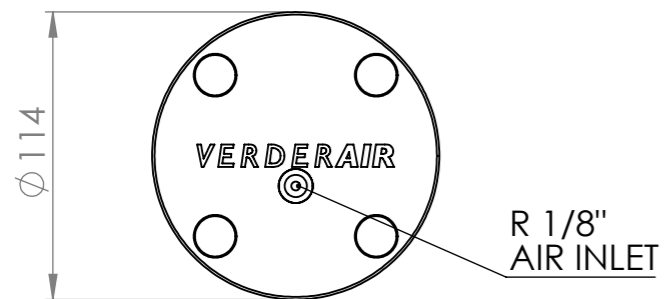
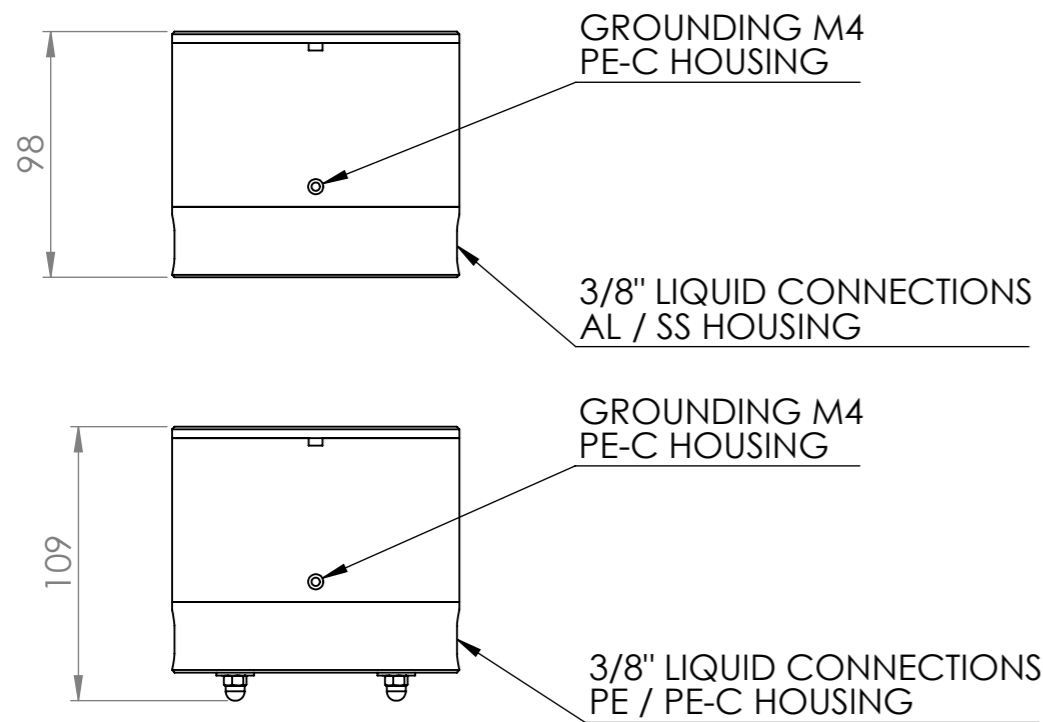

COPYRIGHT OF THIS DRAWING IS OWNED BY "VERDER NV"
COPY OR DISTRIBUTION TO THIRD PARTY IS NOT PERMITTED WITHOUT WRITTEN CONFIRMATION

REMOVE ALL BURRS AND SHARP EDGES
ALL DIMENSIONS ARE IN MM
CAD GENERATED DRAWING, MANUAL CHANGES NOT PERMITTED

0	±0,20
0,0	±0,10
0,00	±0,05
0,000	±0,02

TOLERANCING

CHANGE NO.

DATE

100 mm A3 1:1

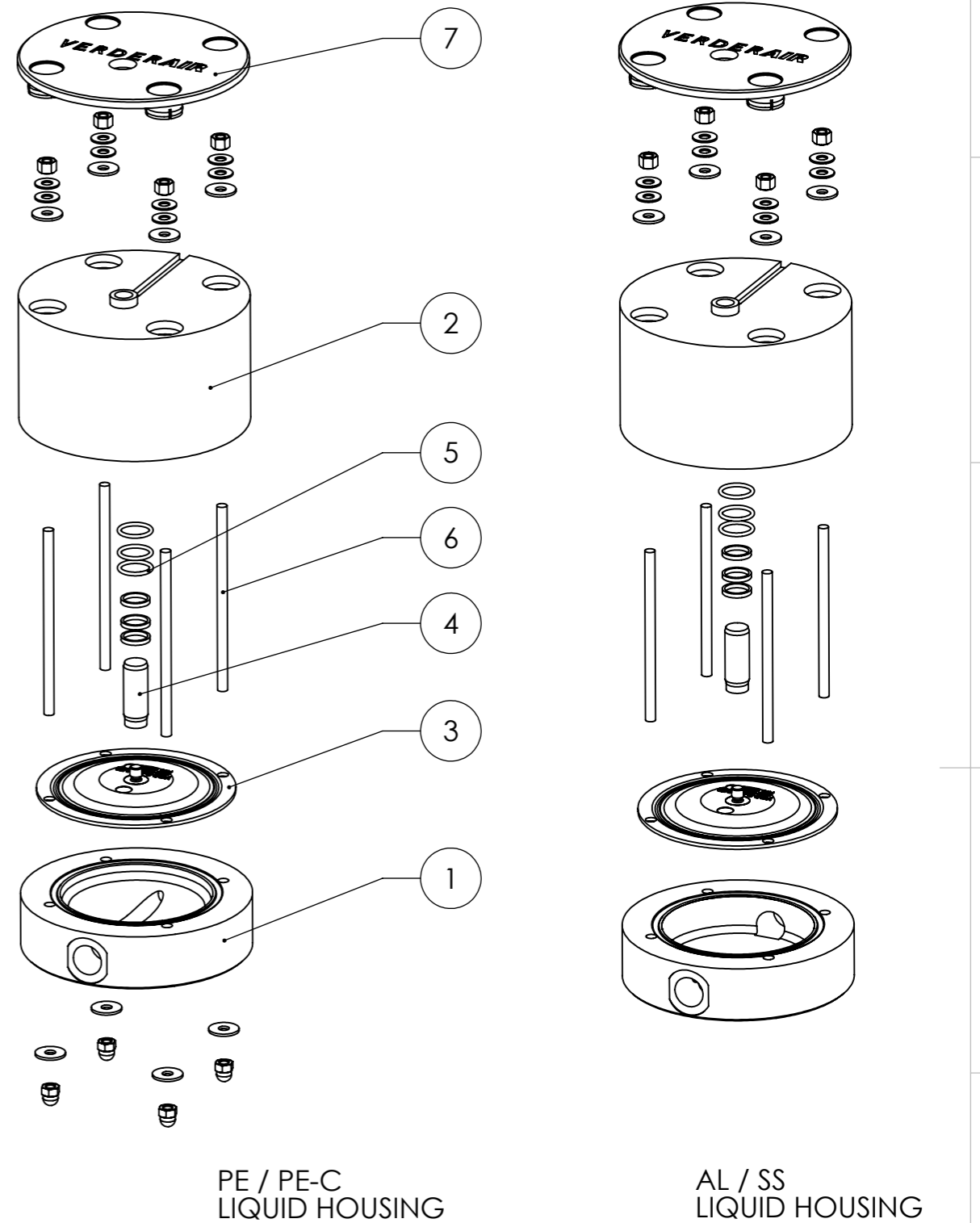

DRAWN	DATE	PRODUCT NUMBER
R. R.	2016-01-14	
CHECKED	DATE	PRODUCT NAME
R. A.	2016-01-14	PD-S10
MATERIAL		
WEIGHT	SCALE	REVISION
	1:3	0.2
SIZE	SHEET	STANDARD SPECIFICATION
A3	1 / 2	

VERDERAIR®
PURE
PASSION FOR PUMPS
www.verderair.com